

EX360 FieldPro with ArcReach®

Processes

- Stick, MIG, Flux-Cored, TIG, RMD®, Pulsed MIG, Gouging

Welding Output

- 10–38 volts, 15–425 amp CC/CV



Input Power

- Auto-Line™, 208-575 volts
- Requires 3- or 1-phase power
- Input voltage 208 volts, 220/230/240 volts, 380/400 volts, 460/480 volts, 575 volts



Features

- Remote in use indicator provides convenient feedback indicating an ArcReach® wire feeder is controlling the power source. Under ArcReach control, process and voltage/amperage adjustments are locked out, preventing accidental changes by personnel or the welding operator
- LED process indicator illuminates the front panel, identifying the active process. Includes carbon arc gouging mode for enhanced arc stability and control, as well as having two stick modes, designed to reduce spatter and enhance arc starts
- Auto Remote Sense™ enables unit to automatically use remote control if connected to remote control receptacle.
- 14-pin receptacle has the flexibility to be used with spool guns, feeders, and remote controls.
- Portable and lightweight, the ArcReach® Stick/TIG Remote paired with an EX360 FieldPro power source allows you to change weld settings at your work area.
- Cable length compensation ensures that the voltage a weld operator sets is the voltage they receive by adjusting voltage based on the weld cable length, even hundreds of feet away from the cable source.
- Auto-Process Select™ automatically sets the power source to the correct weld process based on the polarity applied to the weld accessory.

ArcReach®

- Provides remote control of the power source without a control cable. ArcReach® allows you to change weld settings from your ArcReach® feeder or remote, saving a trip to the power supply using the existing weld cable to communicate welding control information between the feeder or remote and the power source



- More Jobsite Productivity and Efficiency



- Exceptional Arc Performance



- Increased Uptime



- Improved Jobsite Safety



- Maximum Fleet Compatibility



- More Operator Control

Dimensions H x W x L

- H: 17 in. [432 mm]
- W: 12.5 in. [318 mm]
- D: 24 in. [610 mm]

Weight

- 93 lb. [42.2 kg]

Product Number

- 907730004

Red-D-Arc
Welderrentals
reddarc.com

EX360 FieldPro with ArcReach®

EX360 FieldPro Specifications



Input Power	Voltage Range in CV Mode	Amperage Range in CC Mode	Rated Output	Amps Input at Rated Load Output, 60 Hz 208 V 230 V 400V 460V 575V KVA KW	Max. Open Circuit Voltage	Dimensions	Net Weight
3-phase	10-38 volts	5-425 amps	350 amps at 34 VDC 60% duty cycle	40.4 36.1 20.6 17.8 14.1 14.2 13.6	75 VDC	H: 17 in. (432 mm) W: 12.5 in. (318 mm) D: 24 in. (610 mm)	93 lb. (42.2 kg)
1-phase			300 amps at 32 VDC 60% duty cycle	60.8 54.6 29.7 24.5 19.9 11.7 11.2			

ArcReach® SuitCase Specifications



Model	Input Power	Input Welding Circuit Rating	Wire Feed Speed	Wire Type and Diameter Capacity	Max. Spool Size Capacity	Dimensions	Net Weight
8	Operates on open-circuit voltage and arc voltage: 14-48 VDC/ 110 max. OCV	330 amps at 60% duty cycle	50-780 ipm (1.3-19.8 m/min.) dependent on arc voltage	Solid Wire: .023-.052 in. (0.6-1.4 mm) Flux-Cored: .030-5/64 in. (0.8-2.0 mm)	8 in. (203 mm) 14 lb. (6.4 kg)	H: 12.75 in. (324 mm) W: 7.25 in. (184 mm) D: 18 in. (457mm)	28 lb. (13 kg)
12		425 amps at 60% duty cycle			12 in. (305 mm) 45 lb. (20 kg)	H: 15.5 in. (394mm) W: 9 in. (229 mm) D: 21 in. (533 mm)	35 lb. (15.9 kg)

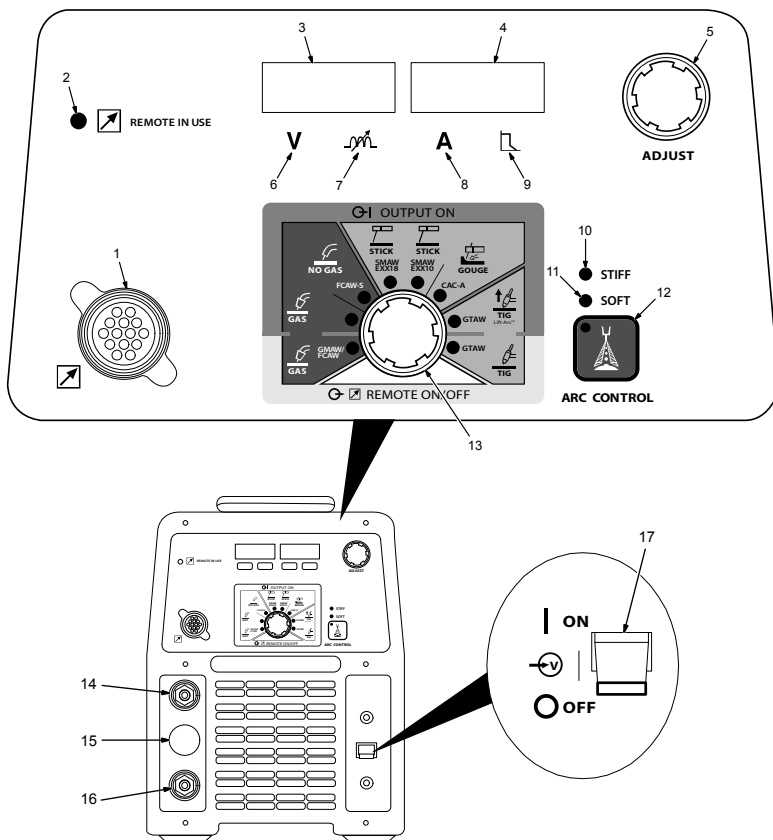

- 1 Remote 14 Receptacle
- 2 Remote In Use Indicator
- 3 Left Display
- 4 Right Display
- 5 Adjust Control
- 6 Volts Indicator
- 7 Arc Control Indicator For Wire
- 8 Modes Amps Indicator
- 9 Arc Control Indicator For Stick Modes
- 10 Arc Control Stiff Indicator
- 11 Arc Control Soft Indicator
- 12 Arc Control Button
- 13 Mode Switch
- 14 Weld Output Terminal (+)
- 15 Optional Gas Valve Knockout
- 16 Weld Output Terminal (-)
- 17 Power Switch